

intraLED 3

The new LED light source intraLED 3 is the ideal lighting system for machine vision applications. It emits very intensive, uniform and naturally light. The compact enclosure allows use on a small surface and smooth system integration. intraLED 3 is a real alternative to halogen light sources. Saving costs can be that efficient and environmentally friendly.



- More than 500lm light output and excellent uniformity
- 50.000 life-time = 5.7 years in continuous mode
- Low power consumption reduces running costs and protects the environment
- Compact aluminium enclosure with M4 threaded rails on 4 sides
- Compatible to light guides from Volpi and Schott-Fostec

Optical Specifications

Light Sender	White high-power LED
Luminous flux at lightguide output*	min. 500 lumen
Color temperature	typ. 6000K
Color Rendering Index	typ. 74%
aperture angle	typ. 0.5
Active lightguide diameter	5mm - 14mm
Life time of LED**	50.000h / 30.000h (L50/L70)

Electrical Specifications

Input voltage	24 VDC +/- 10%
Power consumption	max. 55W
Power supply	external
Protective Circuit	reverse polarity and overheat protected

* Lightguide: Active diameter 13.5mm; NA=0.54; L=1m

** Average life-time at 25°C



Long LED life-time and low power consumption reduce operating costs and protect the environment



Rear view shows (from left to right:) Multiport-input, Com-port (RS-232), Mode-switch, 24-VDC power input

Control / Communication

Manual intensity control
 Modus preset
 Communication interface
 Multiport
 Intensity resolution
 Response time

rotary potentiometer (stepless)
 On / Off / Multiport
 RS-232 (Optional USB)
 Digital and analog inputs
 0.1%
 approx. 7ms (0-10V Step)

Mechanical Specifications

Mechanical lightguide connector
 Enclosure
 IP protection class
 Mounting
 Dimensions in mm (LxBxH)
 Weight (without power supply)

Volpi 15mm / Schott-Fostec 18.3mm
 Anodized aluminium
 IP 3X
 M4 threaded rails (6mm deep)
 173x100x100
 1.6 kg

Environmental Conditions

Operation temperature
 Storage temperature
 Humidity

-10°C to +40°C
 -25°C to +60°C
 30% to 90%, not condensing

Multiport	Pin Assignment	Details
Pin 1	Analog Input	0-10V, max. 10,5V
Pin 2	Analog GND	0V
Pin 3	Trigger Input	Low: 0-0,8V / High: 2,0-24V
Pin 4	Digital GND	0V
Pin 5	NC	No Connection
Pin 6	Error Output	

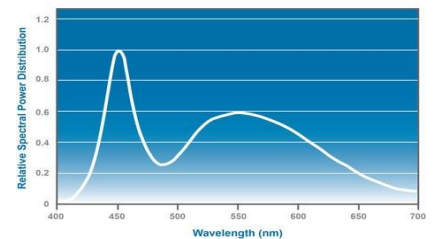
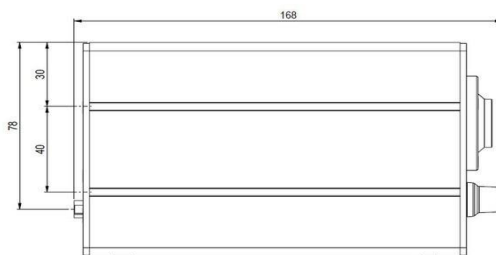
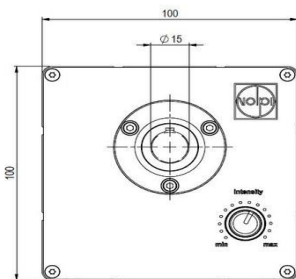
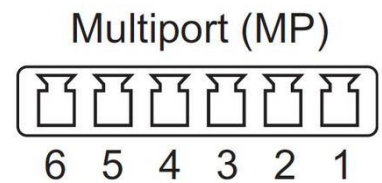

Variants

Product	Part No.
intraLED 3 - LED light source, Fiber Optic and Volpi connector	17501.000
intraLED 3 - LED light source, Schott-Fostec connector	17502.000