

# DATA SHEET



## S5LPJ3799 Correctal® TCL50/0.13

- telecentric lens
- with c-mount
- with fixed iris

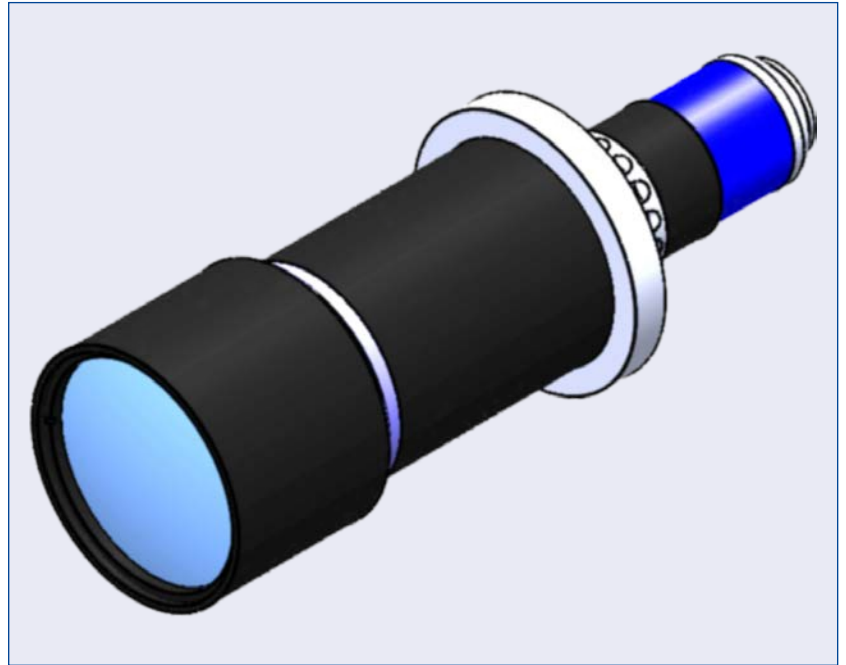
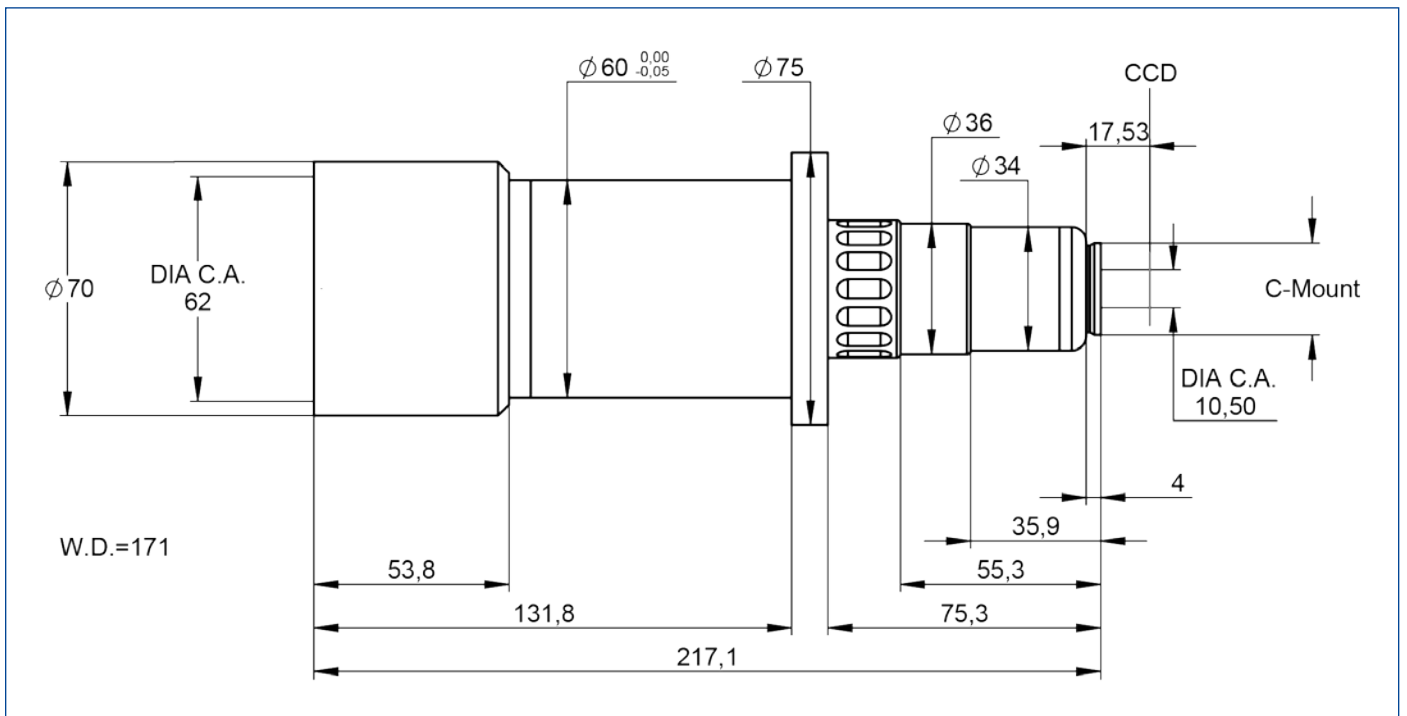

illustration only



outline drawing

# DATA SHEET



## specifications

article number	S5LPJ3799
design wavelength [nm]	450-700
magnification (+/-5%)	0.130
working distance [mm] (+/-2%)	171.0
object size [mm]	36.9 x 27.6
at a chip size of [mm]	4.8 x 3.6 (1/3")
distortion [%]	0.1
object size [mm]	49.2 x 36.9
at a chip size of [mm]	6.4 x 4.8 (1/2")
distortion [%]	0.2
object size [mm]	55,3 x 40,7
at a chip size of [mm]	7.2 x 5.3 (1/1.8")
distortion [%]	0.25
max. telecentricity error [°]	0.1
numerical aperture	0.01
weight [kg]	not yet weighed
flange back distance [mm]	17.53
accessory	S5SET0020

## Distortion for 586 nm

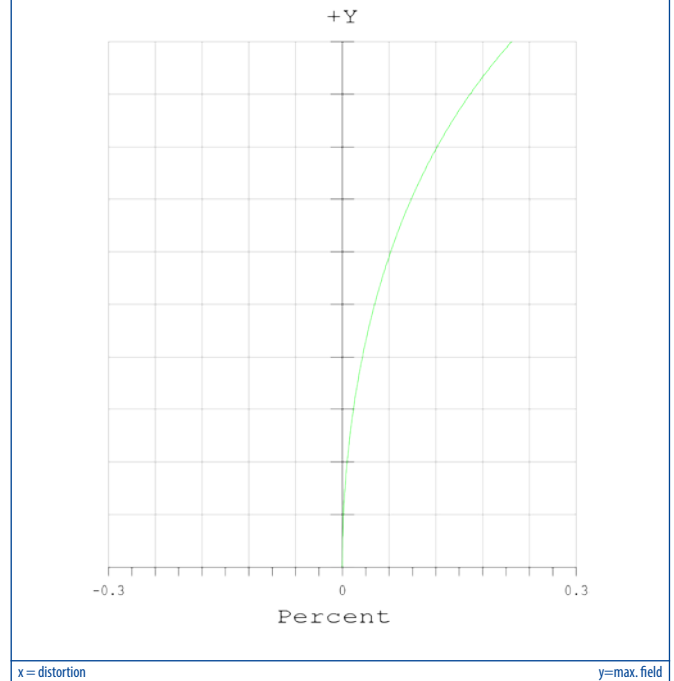

## MTF for various object heights at 586 nm

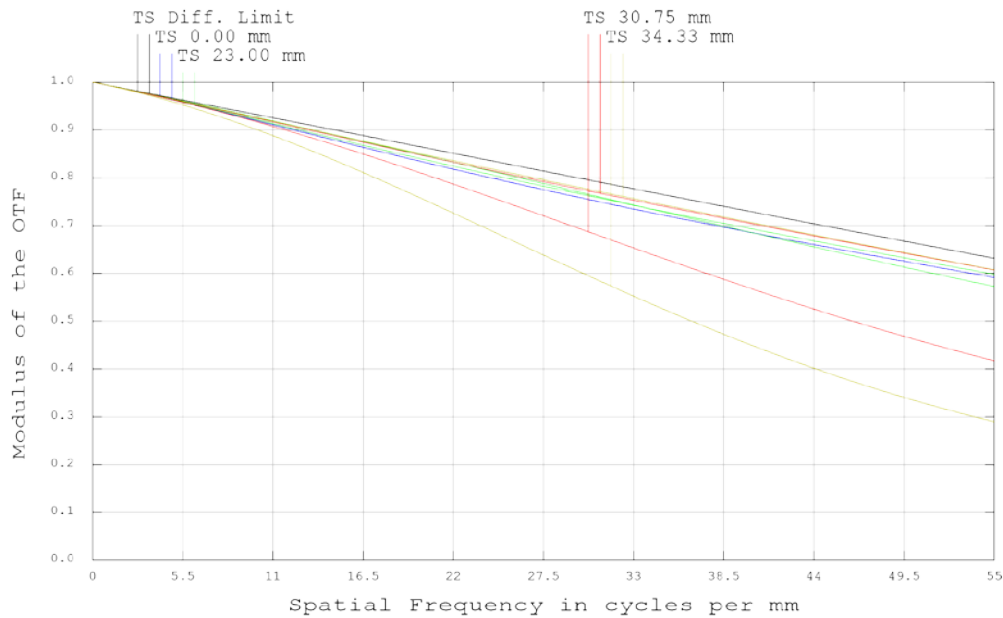

T. tangential

S. sagittal

graphs and data given by design.