

# DATA SHEET



## S5LPJ0625 Correctal® T/1.0

- telecentric lens
- with c-mount
- with variable iris



illustration only

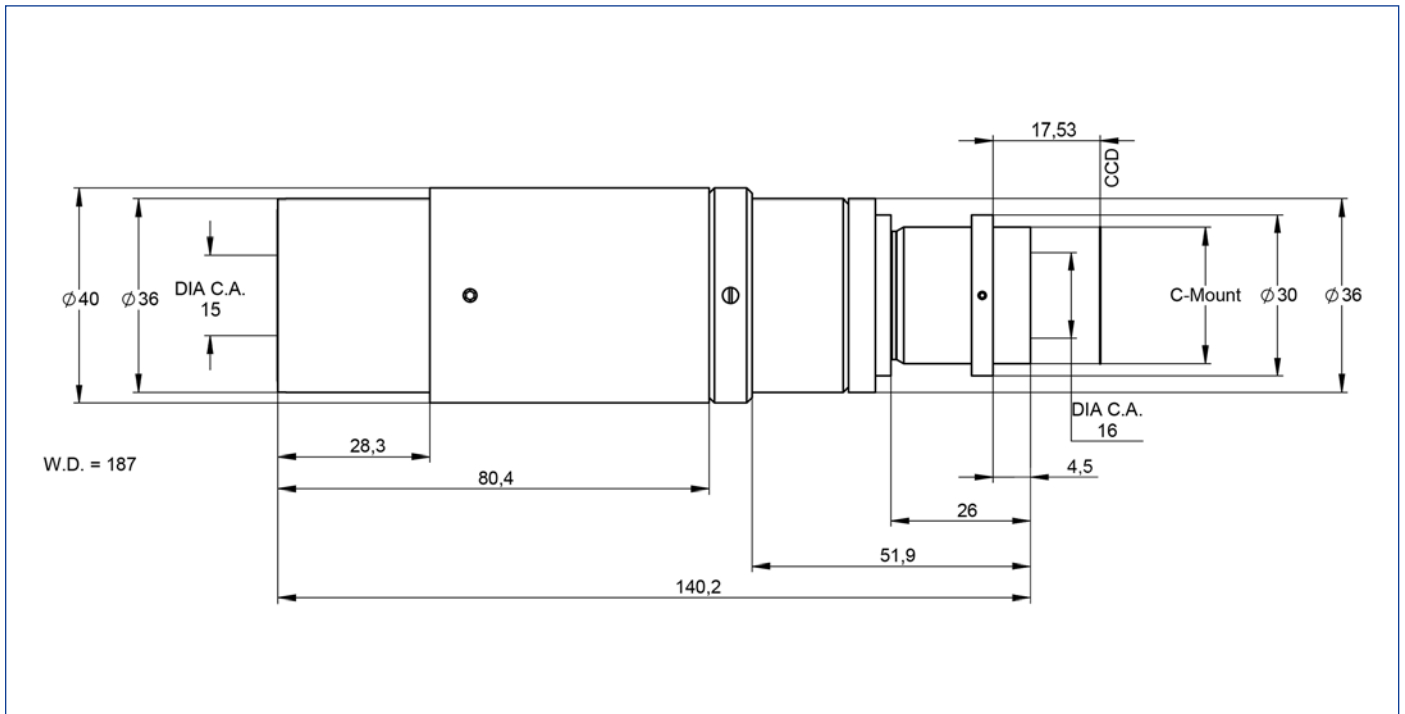

outline drawing

# DATA SHEET



## specifications

article number	S5LPJ0625
design wavelength [nm]	520-580
magnification (+/-5%)	1.000
working distance [mm] (+/-2%)	187.0
object size [mm]	6.4 x 4.8
at a chip size of [mm]	6.4 x 4.8 (1/2")
distortion [%]	0.21
object size [mm]	7.2 x 5.3
at a chip size of [mm]	7.2 x 5.3 (1/1.8")
distortion [%]	0.26
object size [mm]	8.8 x 6.6
at a chip size of [mm]	8.8 x 6.6 (2/3")
distortion [%]	0.38
max. telecentricity error [°]	< 0.01
numerical aperture	0.020
weight [kg]	0.30
flange back distance [mm]	17.53
accessory	S5SET0021, S5SET2135

## Distortion for 550 nm

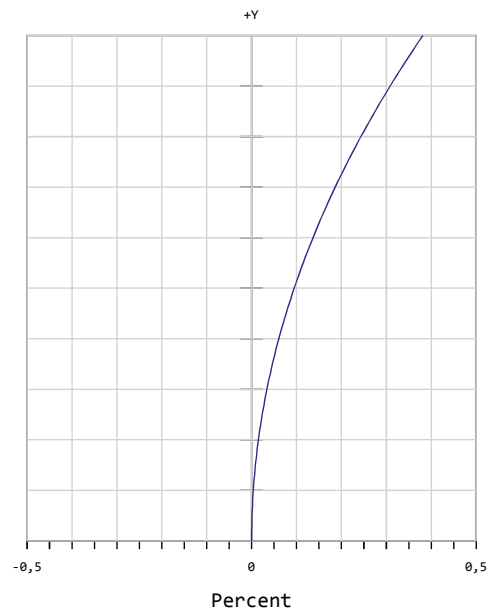

x = distortion

y = max. field

## MTF for various object heights at 550 nm

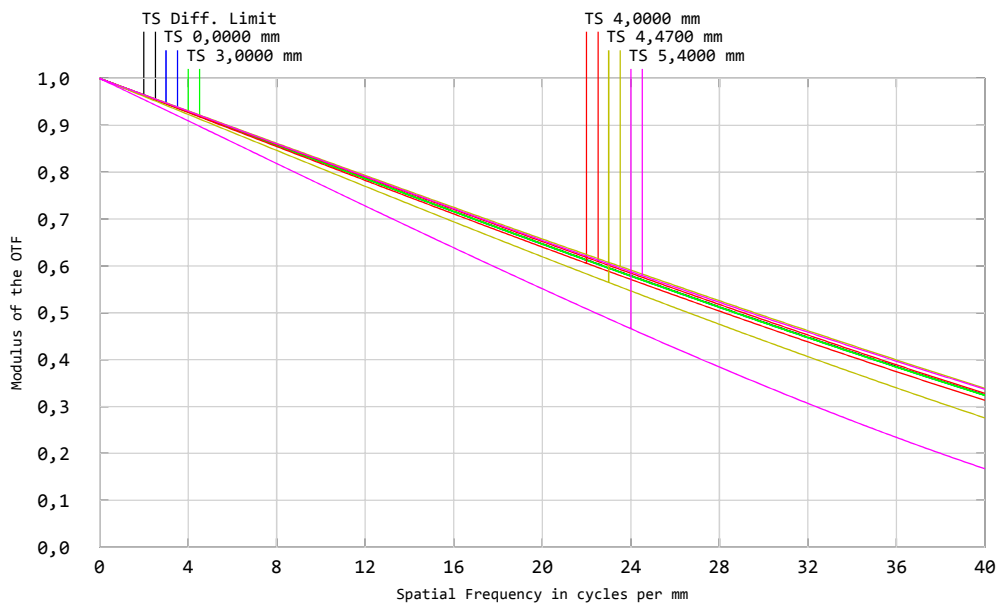

T. tangential

S. sagittal

graphs and data given by design.