

## S5LPJ8265 miniature telecentric lens 2.0x

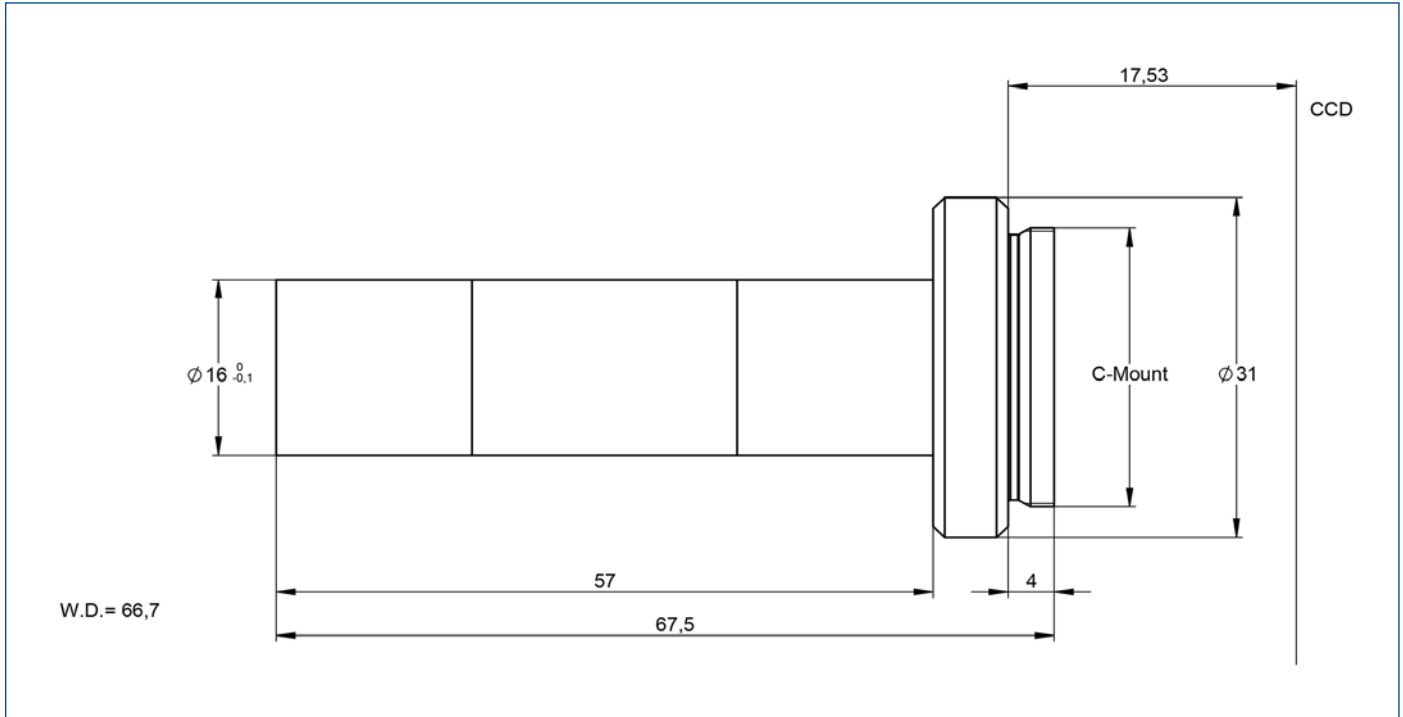

outline drawing

### specifications

article number	S5LPJ8265	numerical aperture (fixed iris)	0.07
wavelength [nm]	450-700	resolution power <sup>1)</sup> [ $\mu\text{m}$ ]	5.11
magnification ( $\pm 5\%$ )	2.000	depth of field [mm]	0,3
working distance [mm] ( $\pm 2\%$ )	66.7	mount	C-mount
max. object size [mm] @ 4.8 x 3.6 (1/3")	2.4 x 1.8	flange focal distance [mm]	17.53
max. object size [mm] @ 6.4 x 4.8 (1/2")	3.2 x 2.4	$\varnothing$ clear aperture [mm]	12.3
max. object size [mm] @ 8.8 x 6.6 (2/3")	4.4 x 3.3	with coaxial illumination <sup>2)</sup>	0
max. distortion [%]	< 0.1	weight [kg]	0.04

#### Notes:

- data given by design

- glueing not possible

<sup>1)</sup> object-sided resolution power @550nm for given fixed numerical aperture

<sup>2)</sup> integrated coaxial illumination with non-polarized beamsplitter, port for  $\varnothing 8$  mm fibre or spot illumination