

DATA SHEET



S5LPJ0423/216 Correctal® TL/3.5

- telecentric lens
- with c-mount
- with variable iris



illustration only

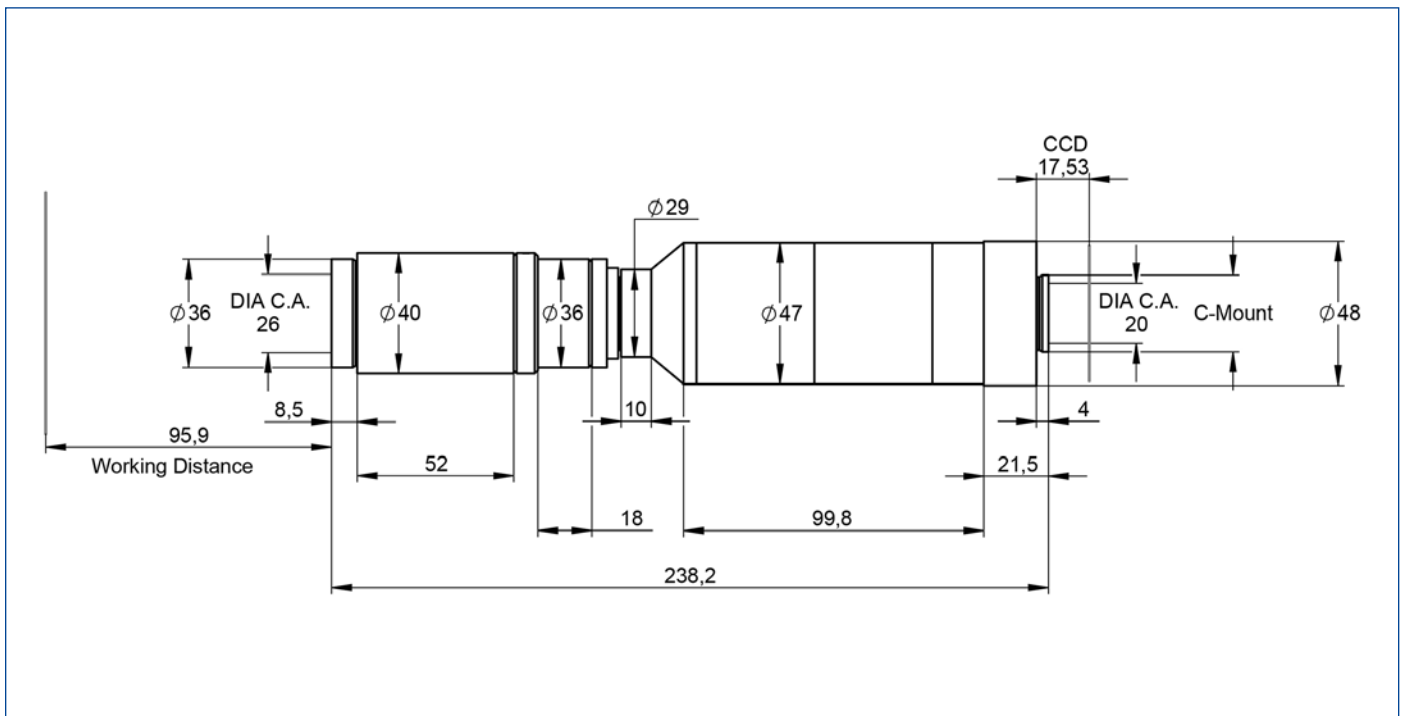

outline drawing

DATA SHEET



specifications

article number	S5LPJ0423/216
design wavelength [nm]	450-700
magnification (+/-5%)	3.500
working distance [mm] (+/-2%)	95.9
object size [mm]	1.8 x 1.3
at a chip size of [mm]	6.4 x 4.8 (1/2")
distortion [%]	<0.05
object size [mm]	2.5 x 1.8
at a chip size of [mm]	8.8 x 6.6 (2/3")
distortion [%]	<0.05
object size [mm]	3.6 x 2.7
at a chip size of [mm]	12.8 x 9.6 (1")
distortion [%]	<0.05
max. telecentricity error [°]	< 0.01
numerical aperture	0.07
weight [kg]	0.50
flange back distance [mm]	17.53
accessory	S5SET0021

Distortion for 586 nm

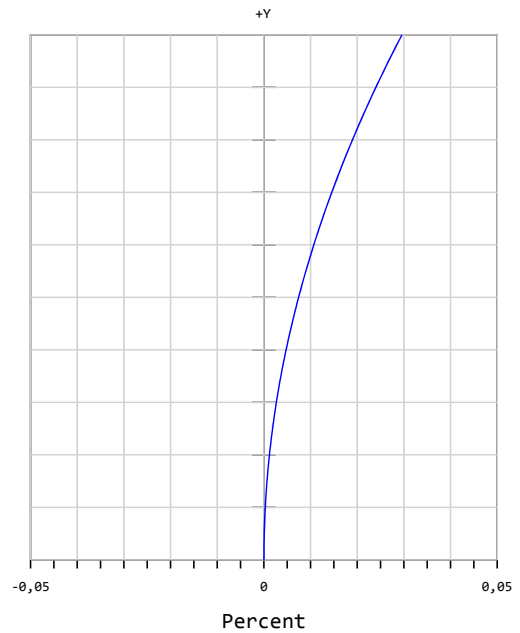

x = distortion

y = max. field

MTF for various object heights at 586 nm

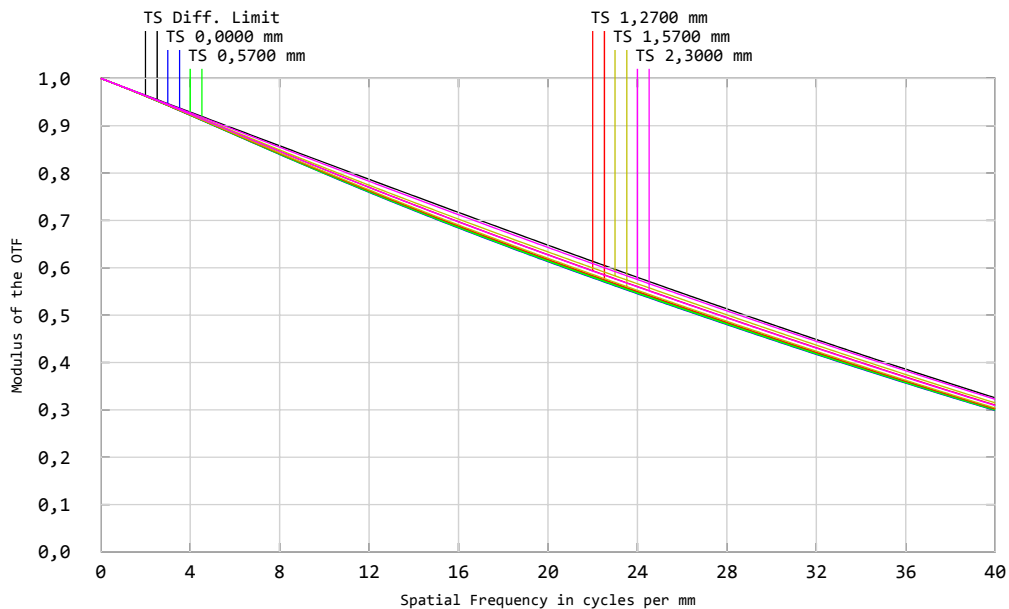

T. tangential

S. sagittal

graphs and data given by design.