



For FA/Machine Vision Fixed Focal

DF6HA-1 B

Applicable camera (model)

1 2/3 1/2 1/3 1/4

FIXED
Fixed Focal

WIDE
Wide Angle

1.5 Mega
For Megapixel
Camera

MANUAL
Manual Iris

C-mt
C Mount

METAL
Metal Mount

F1.2
Wide Aperture Rate



- High-resolution design, providing support for up to 1.5 megapixel camera resolution.
- Low-distortion design achieving accurate image input.
- Compact, lightweight and robust design, supporting various systems.
- Focus & iris lock tab provided, supporting environments such as vibration.

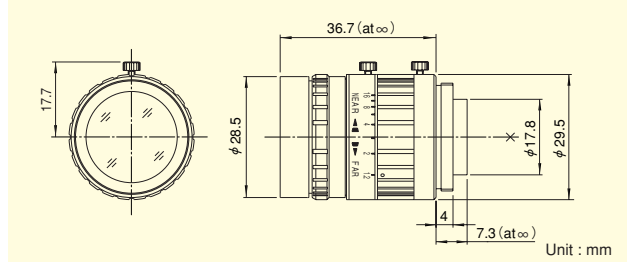

FIXED FOCAL LENGTH LENSES

Focal Length (mm)		6
Iris Range		F1.2 ~ F16
Operation	Focus	Manual
	Iris	Manual
Angle Of View (H×V)	1/2"	56°09' × 43°36'
	1/3"	43°36' × 33°24'
	1/4"	33°24' × 25°22'
Focusing Range (From Front Of The Lens) (m)		∞ ~ 0.1
Object Dimensions at M.O.D. (H×V) (mm)	1/2"	122 × 92
	1/3"	92 × 69
	1/4"	69 × 52
Back Focal Distance (in air) (mm)		11.44
Exit Pupil Position (From Image Plane) (mm)		-46
Filter Thread (mm)		M27 × 0.5
Mount		C
Mass (g)		55

Remarks

- With Metal Mount
- With Locking Knob for Iris and Focus



For FA/Machine Vision Fixed Focal

HF9HA-1 B

Applicable camera (model)

1 2/3 1/2 1/3 1/4

FIXED
Fixed Focal

WIDE
Wide Angle

1.5 Mega
For Megapixel
Camera

MANUAL
Manual Iris

C-mt
C Mount

METAL
Metal Mount

F1.4
Wide Aperture Rate



- High-resolution design, providing support for up to 1.5 megapixel camera resolution.
- Low-distortion design achieving accurate image input.
- Compact, lightweight and robust design, supporting various systems.
- Focus & iris lock tab provided, supporting environments such as vibration.

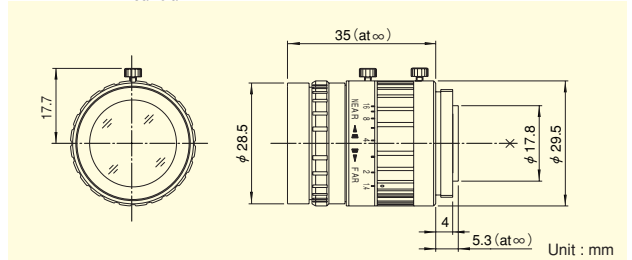

Focal Length (mm)		9
Iris Range		F1.4 ~ F16
Operation	Focus	Manual
	Iris	Manual
Angle Of View (H×V)	2/3"	52°06' × 40°16'
	1/2"	39°09' × 29°52'
	1/3"	29°52' × 22°37'
Focusing Range (From Front Of The Lens) (m)		∞ ~ 0.1
Object Dimensions at M.O.D. (H×V) (mm)	2/3"	108 × 81
	1/2"	79 × 59
	1/3"	59 × 44
Back Focal Distance (in air) (mm)		13.48
Exit Pupil Position (From Image Plane) (mm)		-28
Filter Thread (mm)		M27 × 0.5
Mount		C
Mass (g)		55

Remarks

- With Metal Mount
- With Locking Knob for Iris and Focus

FUJINON CCTV LENS

H-4

WWW.STEMMER-IMAGING.COM · IMAGING IS OUR PASSION

GERMANY
AUSTRIA
Phone: +49 89 80902-0
info@stemmer-imaging.de

UNITED KINGDOM
IRELAND
Phone: +44 1252 780000
info@stemmer-imaging.co.uk

FRANCE
Phone: +33 1 45069560
info@stemmer-imaging.fr

SWITZERLAND
LIECHTENSTEIN
Phone: +41 55 415 90 90
info@stemmer-imaging.ch

THE NETHERLANDS
BELGIUM · LUXEMBOURG
Phone: +31 575 798888
info@stemmer-imaging.nl

STEMMER
IMAGING