



## For FA/Machine Vision Fixed Focal

# DF6HA-1 B

Applicable camera (model)

1 2/3 1/2 1/3 1/4

**FIXED**  
Fixed Focal

**WIDE**  
Wide Angle

**1.5 Mega**  
For Megapixel  
Camera

**MANUAL**  
Manual Iris

**C-mt**  
C Mount

**METAL**  
Metal Mount

**F1.2**  
Wide Aperture Rate



- High-resolution design, providing support for up to 1.5 megapixel camera resolution.
- Low-distortion design achieving accurate image input.
- Compact, lightweight and robust design, supporting various systems.
- Focus & iris lock tab provided, supporting environments such as vibration.

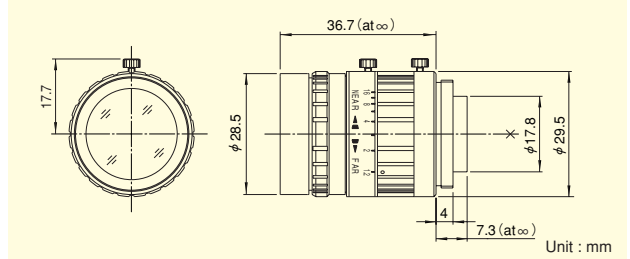

FIXED FOCAL LENGTH LENSES

Focal Length (mm)		6
Iris Range		F1.2 ~ F16
Operation	Focus	Manual
	Iris	Manual
Angle Of View (H×V)	1/2"	56°09' × 43°36'
	1/3"	43°36' × 33°24'
	1/4"	33°24' × 25°22'
Focusing Range (From Front Of The Lens) (m)		∞ ~ 0.1
Object Dimensions at M.O.D. (H×V) (mm)	1/2"	122 × 92
	1/3"	92 × 69
	1/4"	69 × 52
Back Focal Distance (in air) (mm)		11.44
Exit Pupil Position (From Image Plane) (mm)		-46
Filter Thread (mm)		M27 × 0.5
Mount		C
Mass (g)		55

### Remarks

- With Metal Mount
- With Locking Knob for Iris and Focus



## For FA/Machine Vision Fixed Focal

# HF9HA-1 B

Applicable camera (model)

1 2/3 1/2 1/3 1/4

**FIXED**  
Fixed Focal

**WIDE**  
Wide Angle

**1.5 Mega**  
For Megapixel  
Camera

**MANUAL**  
Manual Iris

**C-mt**  
C Mount

**METAL**  
Metal Mount

**F1.4**  
Wide Aperture Rate



- High-resolution design, providing support for up to 1.5 megapixel camera resolution.
- Low-distortion design achieving accurate image input.
- Compact, lightweight and robust design, supporting various systems.
- Focus & iris lock tab provided, supporting environments such as vibration.

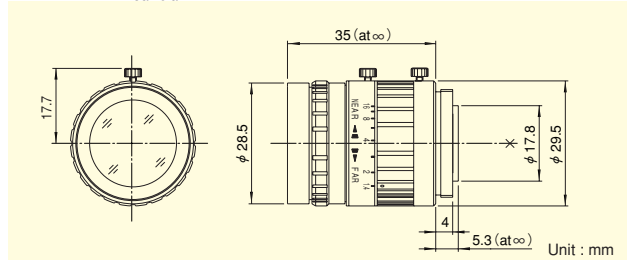

Focal Length (mm)		9
Iris Range		F1.4 ~ F16
Operation	Focus	Manual
	Iris	Manual
Angle Of View (H×V)	2/3"	52°06' × 40°16'
	1/2"	39°09' × 29°52'
	1/3"	29°52' × 22°37'
Focusing Range (From Front Of The Lens) (m)		∞ ~ 0.1
Object Dimensions at M.O.D. (H×V) (mm)	2/3"	108 × 81
	1/2"	79 × 59
	1/3"	59 × 44
Back Focal Distance (in air) (mm)		13.48
Exit Pupil Position (From Image Plane) (mm)		-28
Filter Thread (mm)		M27 × 0.5
Mount		C
Mass (g)		55

### Remarks

- With Metal Mount
- With Locking Knob for Iris and Focus

**FUJINON CCTV LENS**

H-4

WWW.STEMMER-IMAGING.COM · IMAGING IS OUR PASSION

GERMANY  
AUSTRIA  
Phone: +49 89 80902-0  
info@stemmer-imaging.de

UNITED KINGDOM  
IRELAND  
Phone: +44 1252 780000  
info@stemmer-imaging.co.uk

FRANCE  
Phone: +33 1 45069560  
info@stemmer-imaging.fr

SWITZERLAND  
LIECHTENSTEIN  
Phone: +41 55 415 90 90  
info@stemmer-imaging.ch

THE NETHERLANDS  
BELGIUM · LUXEMBOURG  
Phone: +31 575 798888  
info@stemmer-imaging.nl

**STEMMER**®  
IMAGING