

# MC050X

Macro lens for 2/3" detectors, magnification 0.50 x, C-mount

## SPECIFICATIONS

Magnification		0.50
<b>Object field of view</b>		
with 1/3" detector (4.8 x 3.6 mm)	(mm x mm)	9.60 x 7.20
with 1/2.5" detector (5.70 x 4.28 mm)	(mm x mm)	11.4 x 8.6
with 1/2" detector (6.4 x 4.8 mm)	(mm x mm)	12.8 x 9.60
with 1/1.8" detector (7.13 x 5.37 mm)	(mm x mm)	14.3 x 10.7
with 2/3" - 5 MP detector (8.45 x 7.07 mm)	(mm x mm)	16.9 x 14.1
<b>Optical specifications</b>		
Working distance	(mm)	75
Distortion	(%)	< 0.02
F/# (wF/#) 1		5.3 (8)
Field depth	(mm)	2.1
<b>Mechanical specifications</b>		
Length 2	(mm)	35.7
Diameter	(mm)	15.0
Height	(mm)	30
Mass	(g)	64
Mount		C

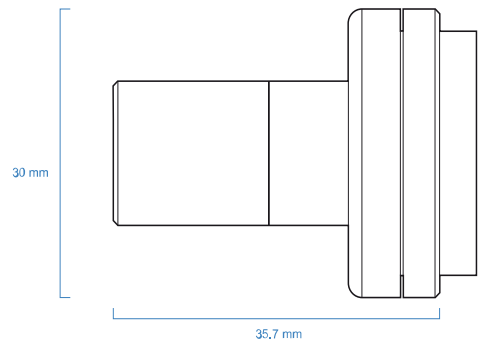

## NOTES

1. F/# = F-number, wF/# = working F-number, the real F-number of a lens when used as a macro.
2. Measured from the front end of the mechanics to the camera flange.

