

# Optronis

*Make time visible*

## CamRecord

### CR600x2



## HIGH-SPEED VIDEO CAMERA

**Compact and light sensitive  
High-Speed camera with 500 fps**

- > **500 fps (images/second)**
- > **Very compact housing**
- > **Very high light sensitivity**
- > **Resolution 1280 x 1024 pixels**
- > **Gigabit Ethernet Interface**
- > **Monochrome / Color**
- > **Up to 16 GB internal memory**
- > **User friendly software**

# CamRecord CR600x2

Insight allows understanding.

Performance (Examples)		
Framerate / second (maximum)	Resolution (H x V)	Recording Time (16 GB, max. Framerate)
500 fps	1280 x 1024	26 sec
1200 fps	800 x 600	27 sec
2000 fps	512 x 512	30 sec
6500 fps	256 x 256	36 sec
16000 fps	128 x 128	60 sec
UltraFormat Performance (Examples)		
Framerate / second (maximum)	Resolution (H x V)	Recording Time (16 GB, max. Framerate)
500 fps	2560 x 2048	26 sec
1200 fps	1600 x 1200	27 sec
2000 fps	1024 x 1024	30 sec
6500 fps	512 x 512	36 sec
16000 fps	256 x 256	60 sec

Model Overview	
CR600x2 /options	Description
/2GB /4GB /8GB or /16GB	Memory size in GB
/M or /C	Monochrome or color sensor
/FM or /CM	Nikon F-Mount or C-Mount
/UF	UltraFormat

Optional accessories
LabView driver (Part number CR-LabView)
Software development kit (Part number CR-SDK)
Lenses, lights, tripod, trigger switches and more accessories on request.

Connector Pin Assignment			
4-pin LEMO FGG0B304CLAD52Z			
Pin 1	Sync IN	Pin 2	Trig IN
Pin 3	GND	Pin 4	Sync OUT

Specifications	
Resolution	1280 x 1024 pixel 2560 x 2048 pixel (UltraFormat)
Frame Rate @ Max. Resolution	500 fps
Image Sensor	Progressive Scan CMOS
Exposure Time	1 $\mu$ s - 1/Framerate
Active Area	17,92 mm x 14,34 mm
Sensor Diagonal Dimension	22,95 mm
Pixel Size	14 $\mu$ m x 14 $\mu$ m
A/D Conversion	10 Bit or 8 Bit
Dynamic	60 dB (90 dB optical)
Sensitivity	25 V/lux*s
Shutter	global electronic, >1 $\mu$ s exposure time
Trigger Signal	TTL, switch, open collector, rising or falling edge, on image content variation
Synchronization	internal, external
Interface	Gigabit Ethernet
Video Output	VGA
Power	12 VDC / 12 W
Lens Mount	Nikon F-Mount (optional C-Mount)
Weight	1050 g
Operating Temperature	0 .. 40°C
Humidity	< 80 % relative, non-condensed
Dimensions	145 mm x 95 mm x 78,5 mm
Conformity	CE, RoHS
Scope of delivery	Camera CR600x2, 5 m GigE cable, power supply, manual, trigger cable and CamControl software for Windows.

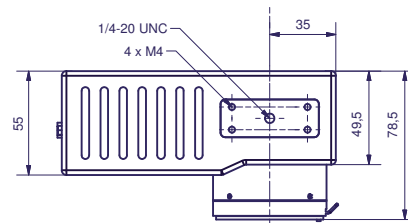
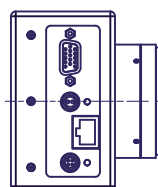
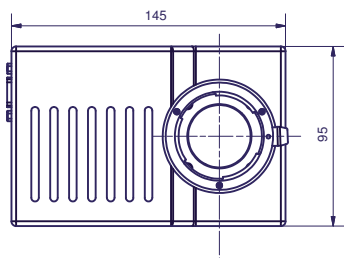
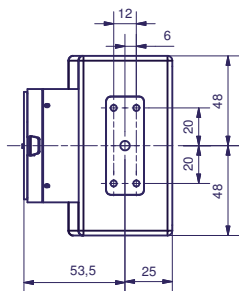

The information given herein is believed to be reliable, however Optronis makes no warranties as to its accuracy or completeness. This data sheet is subject to modifications without prior notice. 02/2009

WWW.STEMMER-IMAGING.COM · IMAGING IS OUR PASSION

GERMANY  
AUSTRIA  
Phone: +49 89 80902-0  
info@stemmer-imaging.de

UNITED KINGDOM  
IRELAND  
Phone: +44 1252 780000  
info@stemmer-imaging.co.uk

FRANCE  
Phone: +33 1 45069560  
info@stemmer-imaging.fr

SWITZERLAND  
LIECHTENSTEIN  
Phone: +41 55 415 90 90  
info@stemmer-imaging.ch

THE NETHERLANDS  
BELGIUM · LUXEMBOURG  
Phone: +31 575 798888  
info@stemmer-imaging.nl

**STEMMER**®  
IMAGING